

Quick Guide of Matching Mamibot Exvac660 with Amazon Echo Smart Devices

Preparation:

- 1) Wi-fi network that can connect to Amazon services;
- 2) A device of Echo, e.g., **Amazon Echo, Echo Tap or Echo Dot**;
- 3) **Registered ID of Amazon**, if you have not registered Amazon ID, please go to www.amazon.com to register;
- 4) **Smart Device APP**, e.g., **[Weback]** you have not downloaded this APP, please search **[Weback]** from Appstore (for IOS system) or Googleplay (for Android system) to download;
- 5) Register ID of **[Weback]** via email or phone number, please refer to **[Quick Guide for APP Using Weback Version]**. Please only use **[Weback]** APP if you're going to use your Amazon Echo match with your robot vacuum cleaner.

Note: When you add Exvac660 to **[Weback]** APP, please rename your device (robot vacuum cleaner) only in English, for example, "Mamibot".

Download Amazon Alexa App

Search Amazon Alexa  and download.

Setting Up Amazon Alexa

- 1) Connect Amazon Echo devices to power supply, make sure wi-fi network is ready for connection;
- 2) Click Amazon Alexa App  on your phone;
- 3) Input your registered Amazon ID and password, **Sign in [Fig 1]**;
- 4) Choose **Settings [Fig 3]** from **upper left [Fig 2]** of Amazon Alexa App, click **Set Up a New Device [Fig 4]** to add your device;
- 5) Choose your Amazon Echo type **[Fig 5]**;
- 6) Choose the Language **[Fig 6]**;
- 7) Click Connect to Wi-Fi **[Fig 7]**;
- 8) Long Press the small dot **[Fig 8]** on your Echo Device for 5 seconds, until Echo Light turns to **Orange**, click **Continue**;

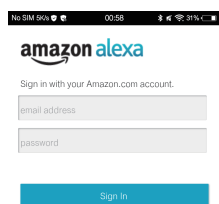

Fig 1

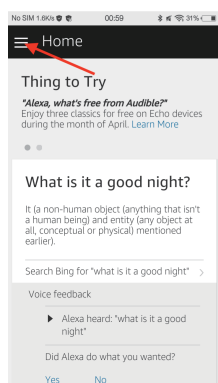

Fig 2

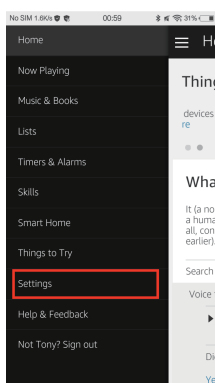

Fig 3

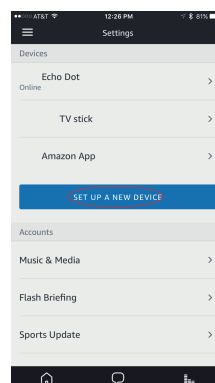

Fig 4

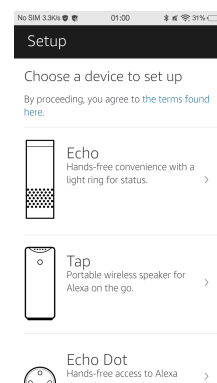

Fig 5

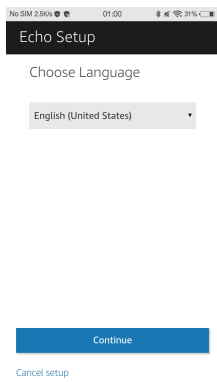

Fig 6

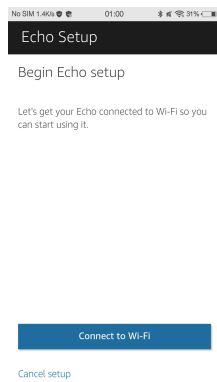

Fig 7



Fig 8

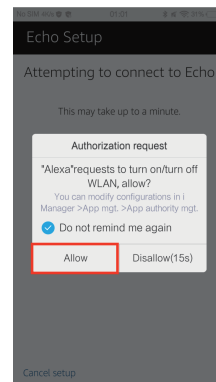

Fig 9

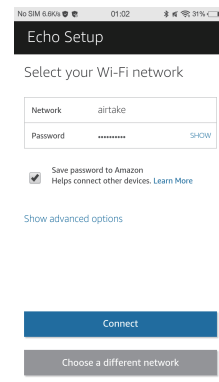

Fig 10

- 9) Choose your own Wi-fi network and allow for continue [Fig 9];
 10) Input your password to continue connection [Fig 10], it takes few minutes for Echo to connect with your network [Fig 11];
 11) Wi-fi connection is completed and click Continue to return Echo to homepage [Fig 12], Echo Set up completed.

Connect Weback ID with Amazon Echo

- 12) Return to Alexa Homepage find **Skills** [Fig 13];
 13) Search [Weback] App [Fig 14], choose **ENABLE SKILL** [Fig 15], Weback skill is on;
 14) Input your Weback ID and Password to link Weback APP to Amazon Alexa [Fig 16], when it shows "Alexa has been successfully linked with Smart Life" [Fig 17], it means Weback ID is connected;

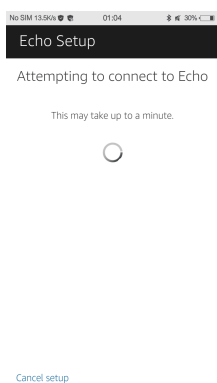

Fig 11

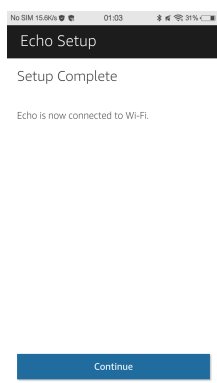

Fig 12

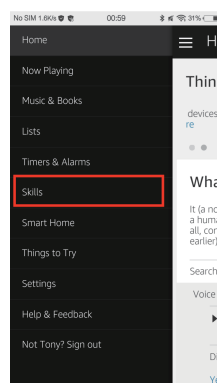

Fig 13

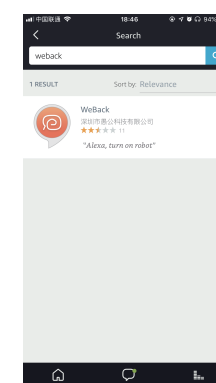

Fig 14

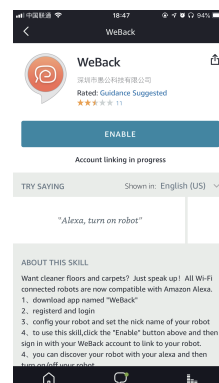

Fig 15

Device Discovering and Controlling

- 15) Choose **Smart Home** [Fig 18], click Discover [Fig 19] to discover your robot vacuum;
 16) In few seconds your Mamibot robot is discovered [Fig 20] (e.g., the name you've put as "mamibot", now you can control your Mamibot Exvac660 via Amazon Echo.

Note: Now the APP has only few skills like **left Turn On/Turn Off mamibot**, we are developing to improve its skills with more commands. Skills will be updated without prior notice.

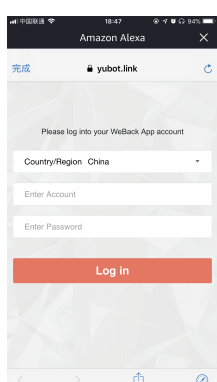

Fig 16

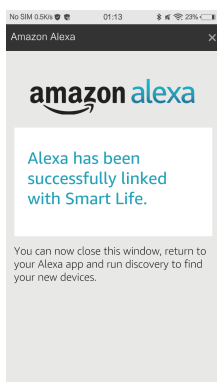

Fig 17

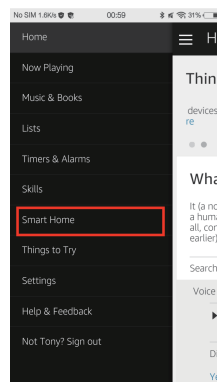

Fig 18

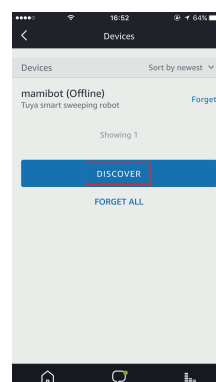

Fig 19

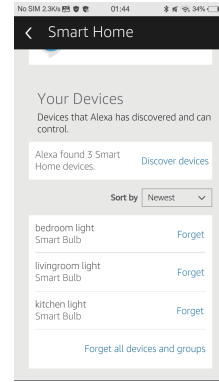

Fig 20